



## SAN110

(6904-100139 <00>)

### IMPORTANT SAFETY INSTRUCTIONS - SAVE THESE INSTRUCTIONS

Thank you for choosing a Sanus Accents wall mount. The SAN110 is designed to mount LCD flat panels with VESA (Video Electronics Standards Association) hole pattern up to 200mm x 200mm and weighing up to 100 lb [45.5 Kg] to a vertical wall. It will allow the television to be pulled out 9.5" [241.3 mm] from of the wall. It will allow you to swivel the television  $\pm 30^\circ$  (may vary with size of television), tilt  $+5^\circ$  to  $-15^\circ$ , and have a  $\pm 6^\circ$  roll control.

#### CAUTION

Do not use this product for any purpose not explicitly specified by Sanus. Improper assembly may cause property damage or personal injury. If you do not understand these directions, or have doubts about the safety of the assembly, contact Customer Service or call a qualified contractor. Sanus is not responsible for damage or injury caused by incorrect assembly or use.

#### WARNING

**This product contains small items that could be a choking hazard if swallowed. Keep these items away from young children!**

#### CAUTION

This product is designed for use in wood stud walls only! The wall must be capable of supporting up to five times the weight of the monitor and mount combined. If you have any doubts about the ability of the wall to support the monitor, contact Customer Service, or a qualified contractor.

---

**Sanus Systems** 2221 Hwy 36 West, Saint Paul, MN 55113 USA

Customer Service: 1-800-359-5520 • 651-484-7988

info@sanus.com • www.sanus.com

©2008 Milestone AV Technologies. All rights reserved.

Sanus is a division of Milestone. All other brand names or marks are used for identification purposes and are trademarks of their respective owners.

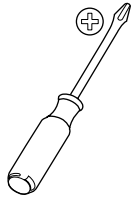
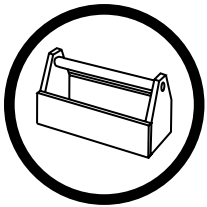

3/16 in.

## Supplied Parts and Hardware

Before starting assembly, verify all parts are included and undamaged. If any parts are missing or damaged, do not return the item to your dealer; contact Customer Service. Never use damaged parts!



Hardware and procedures for multiple mounting configurations are included. When you see this symbol, choose the correct configuration to suit your needs. Not all hardware included will be used.

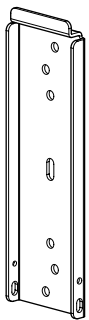

[01] x 1

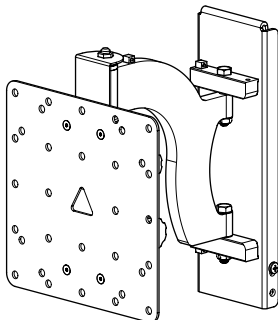

[02] x 1

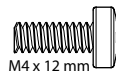

M4 x 12 mm

[03] x 4



M5 x 12mm

[04] x 4

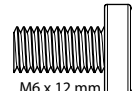

M6 x 12 mm

[05] x 4

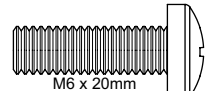

M6 x 20mm

[06] x 4

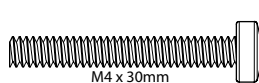

M4 x 30mm

[07] x 4



M5 x 30mm

[08] x 4



M6 x 35mm

[09] x 4

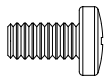

[10] x 2

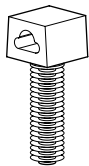

[11] x 3

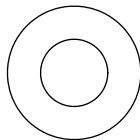

[12] x 3

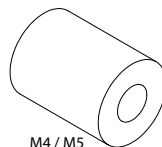

M4 / M5

[13] x 4

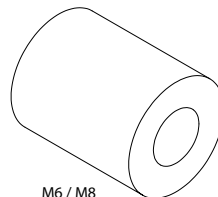

M6 / M8

[14] x 4

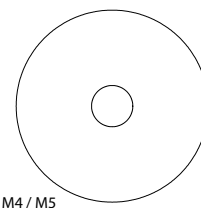

M4 / M5

[15] x 4

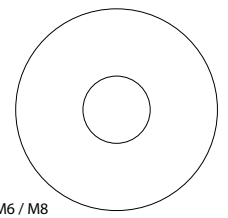

M6 / M8

[16] x 4

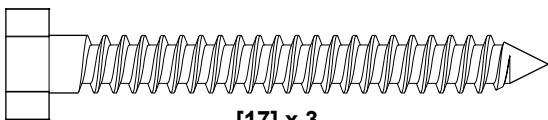

[17] x 3

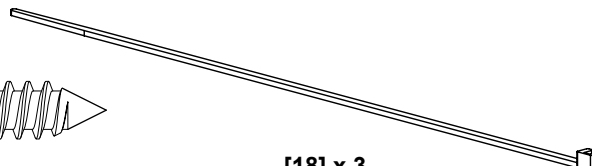

[18] x 3

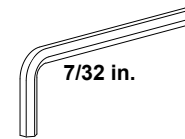

7/32 in.

[19] x 1

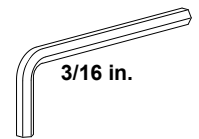

3/16 in.

[20] x 1

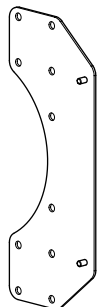

[21] x 2

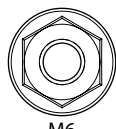

M6

[22] x 4

# 1: Attach Plate to Wall

## CAUTION

Do not overtighten lag bolts [17]. Tighten Lag Bolts until the Lag bolt Washer [12] is pulled firmly against the Wall plate [01]. If there is a layer of drywall or other material, this drywall or other material may not exceed 1/2 inch (13 mm) in thickness. Failure to heed this caution may result in property damage and/or personal injury.

**NOTE:** The TV will be vertically centered on the Wall Plate once it is mounted.

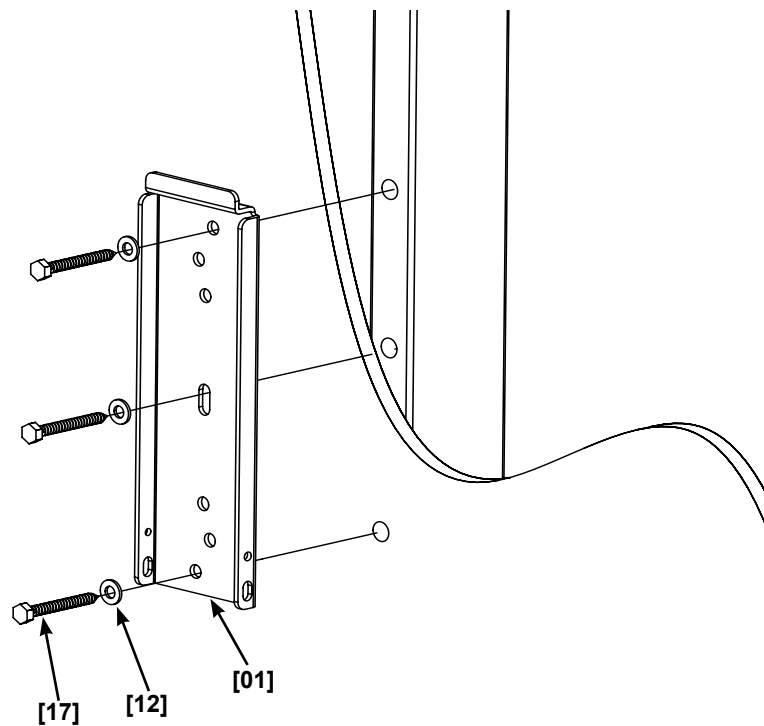

## 2: Attach Optional Brackets

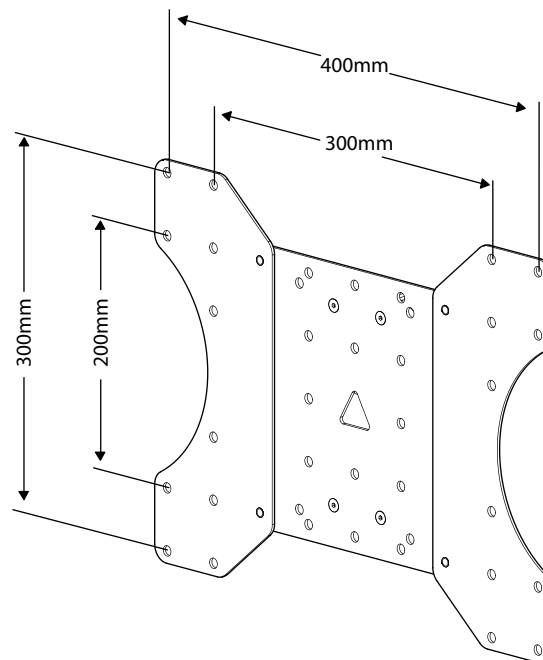
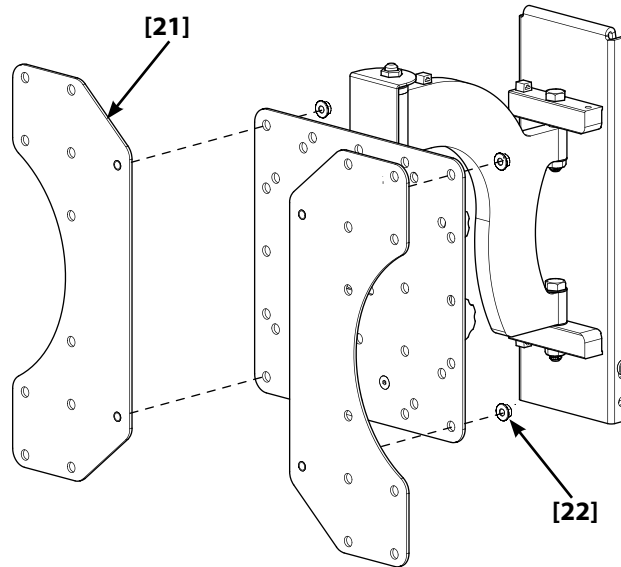

# 3: Install Monitor Brackets

For Televisions with Flat Backs

M5 Diameter Bolt

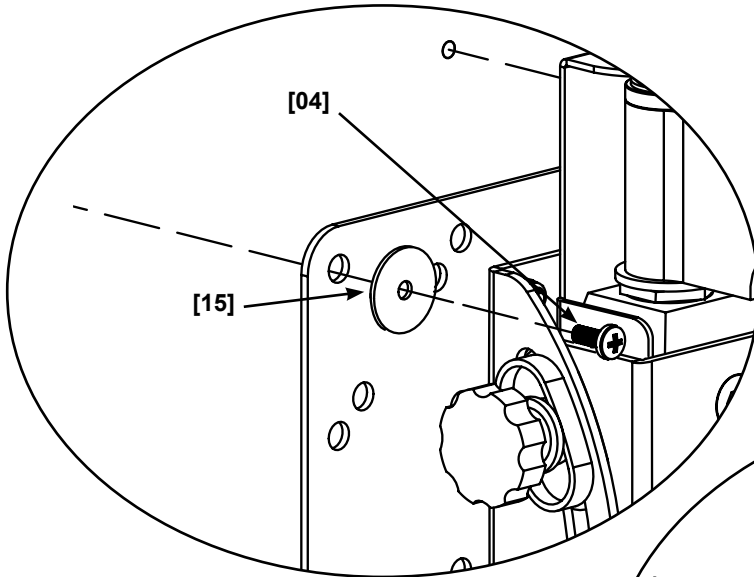

M6 Diameter Bolt

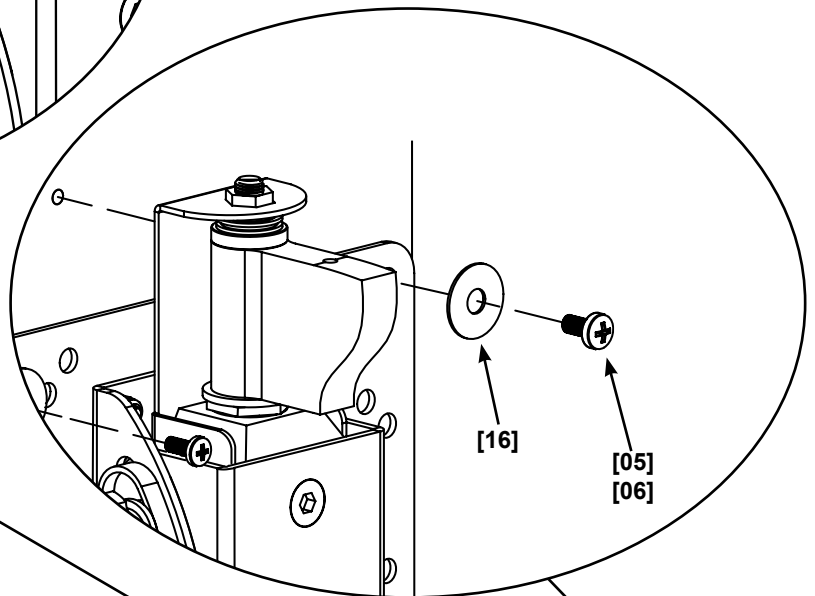

M4 Diameter Bolt

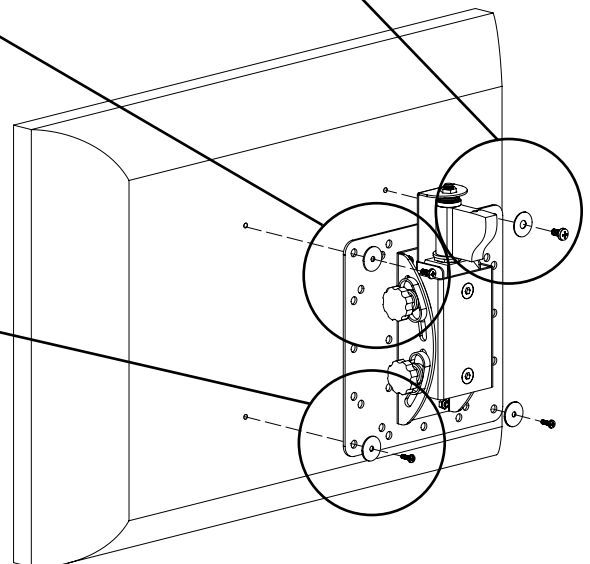
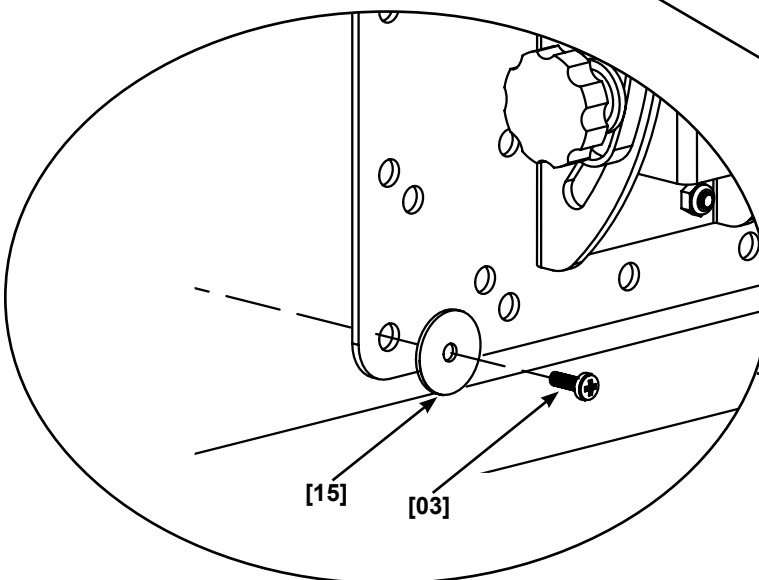

# 3-1: Install Monitor Brackets

For Televisions with Curved Backs

M5 Diameter Bolt

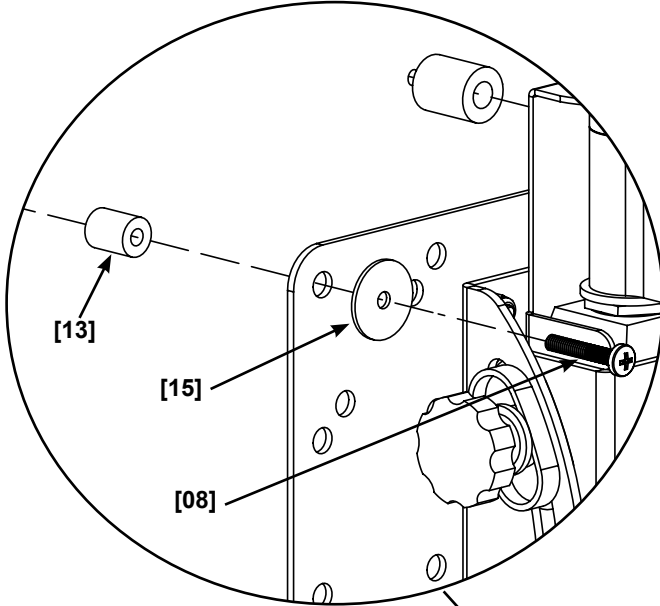

M6 Diameter Bolt

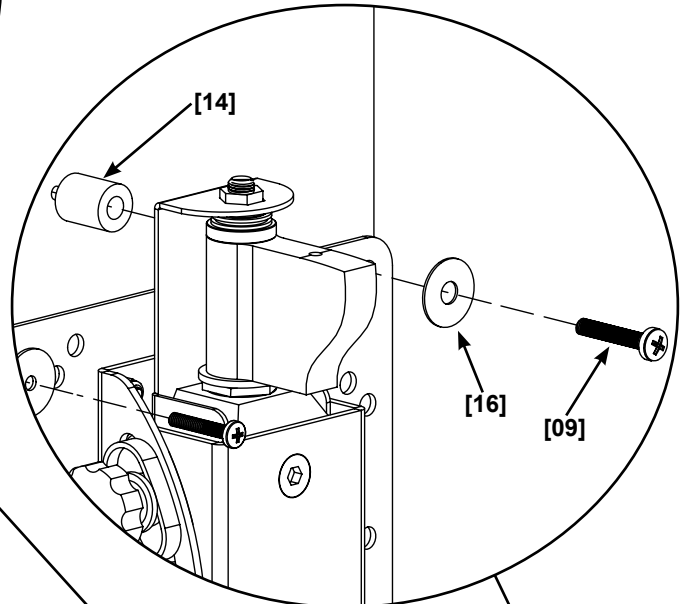

M4 Diameter Bolt

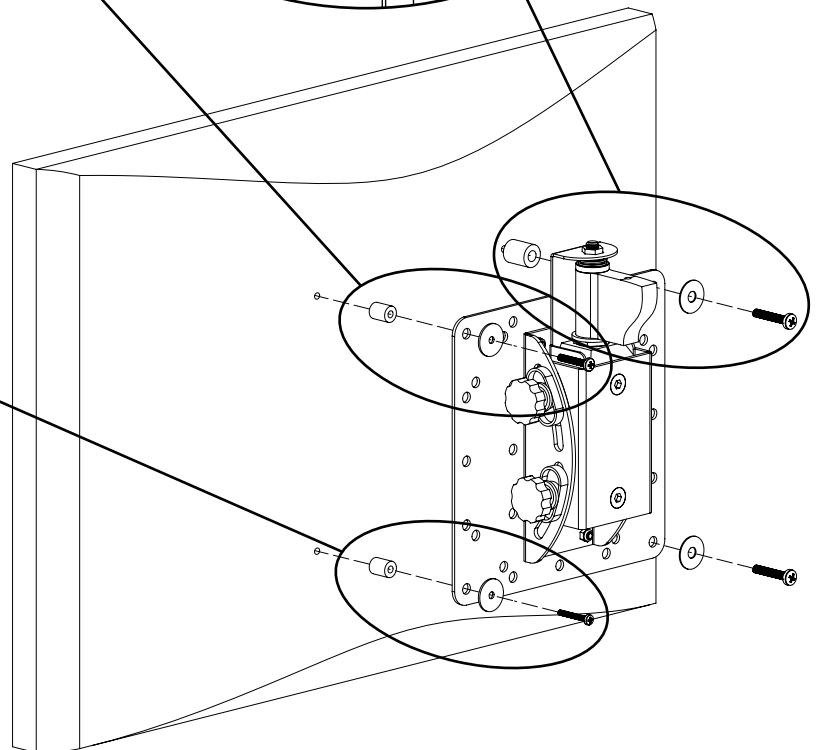
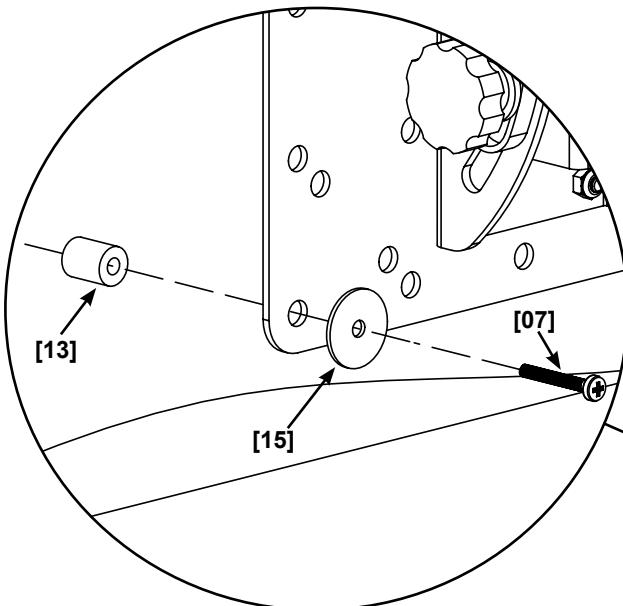

## 4: Attach Monitor to Plate

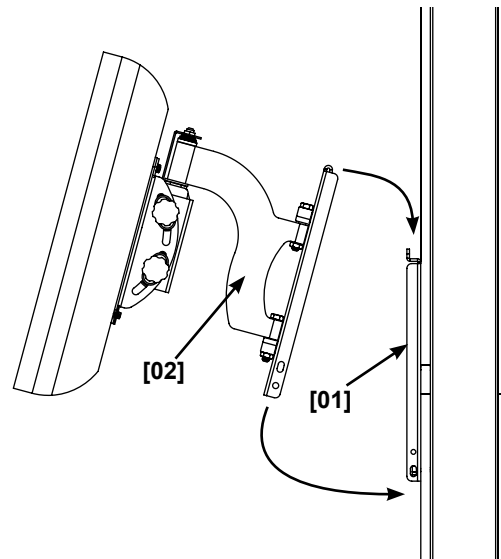

## 5: Add Safety Bolts

### CAUTION

Be sure the Safety Bolt [10] is tight. A loose Safety bolt will result in an unstable installation which may result in property damage and/or personal injury.

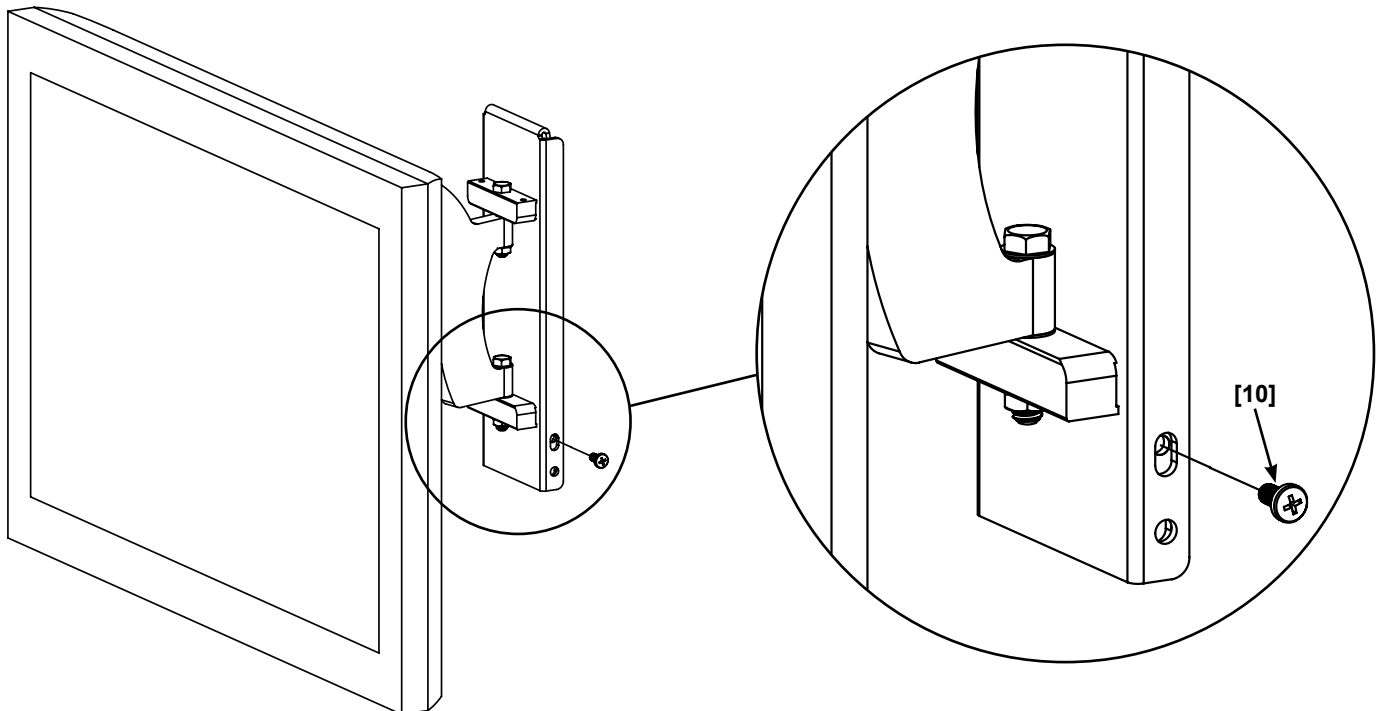

**NOTE:** Lower Hole on transfer bracket may be used to add a padlock for added security.

## 6: Cable Management

### CAUTION

Do not run cables through a pinch point. Running cables through pinch points may result in damage to the cables and/or personal injury.

Before beginning cable management pull the television into the position as far from the wall as possible. Leave some slack in the cables so that during motion so there is no added tension on the connectors. Wire Tie Clips **[11]** can be attached to the holes in the top and the bottom of the Arm Assembly **[02]** by simply pressing them into place as shown in the Detailed View of Diagram 7. Wire Ties **[18]** can then be added to the Wire Tie Clips **[11]**.

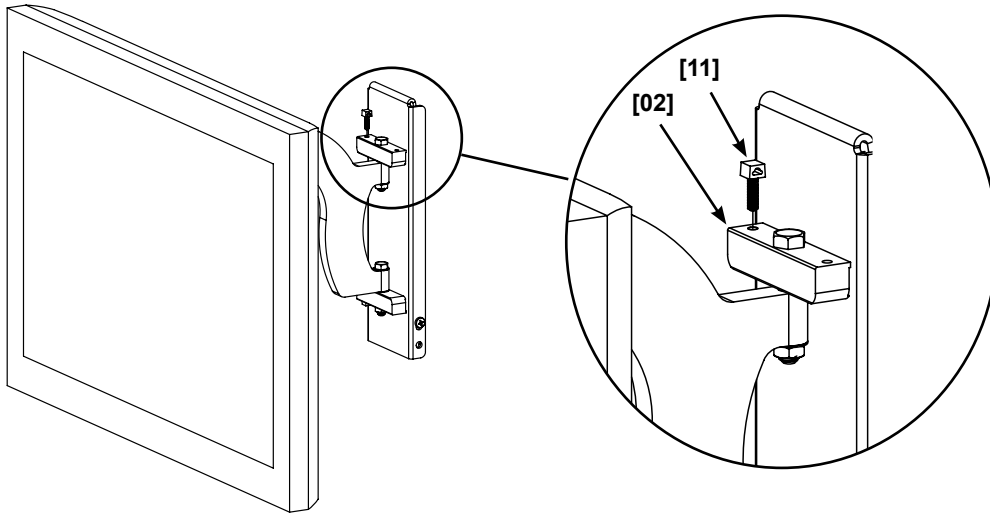



## 7: Adjust Left/Right Swivel

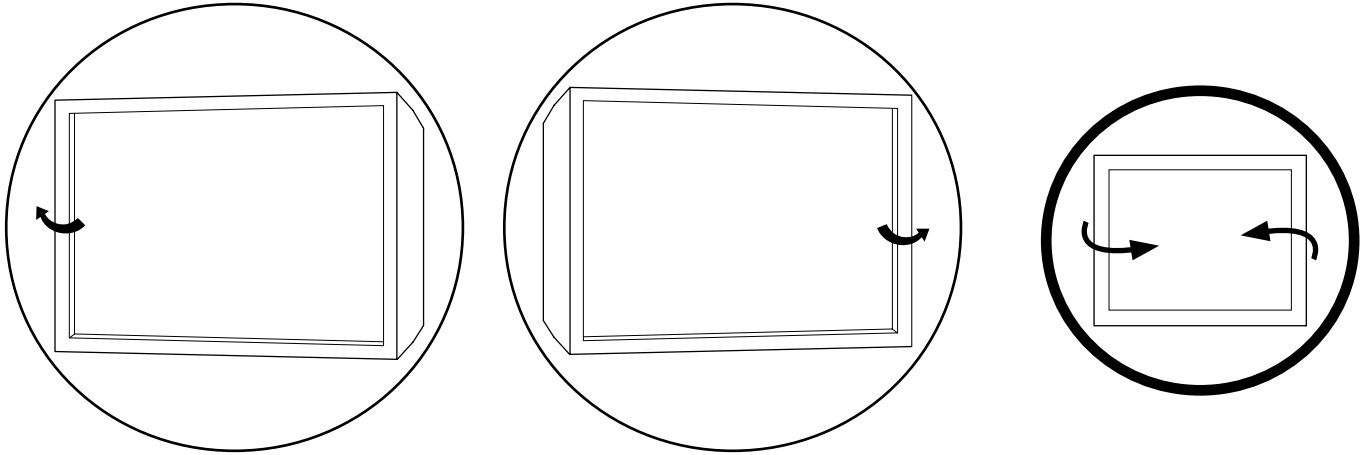

### CAUTION

Avoid potential injuries or property damage! Remove the safety bracket **[B]** only to adjust the swivel tension nut **[N]**. Be sure to replace the safety bracket after adjusting the swivel tension nut. The hex hole in the safety bracket must seat over the swivel tension nut.

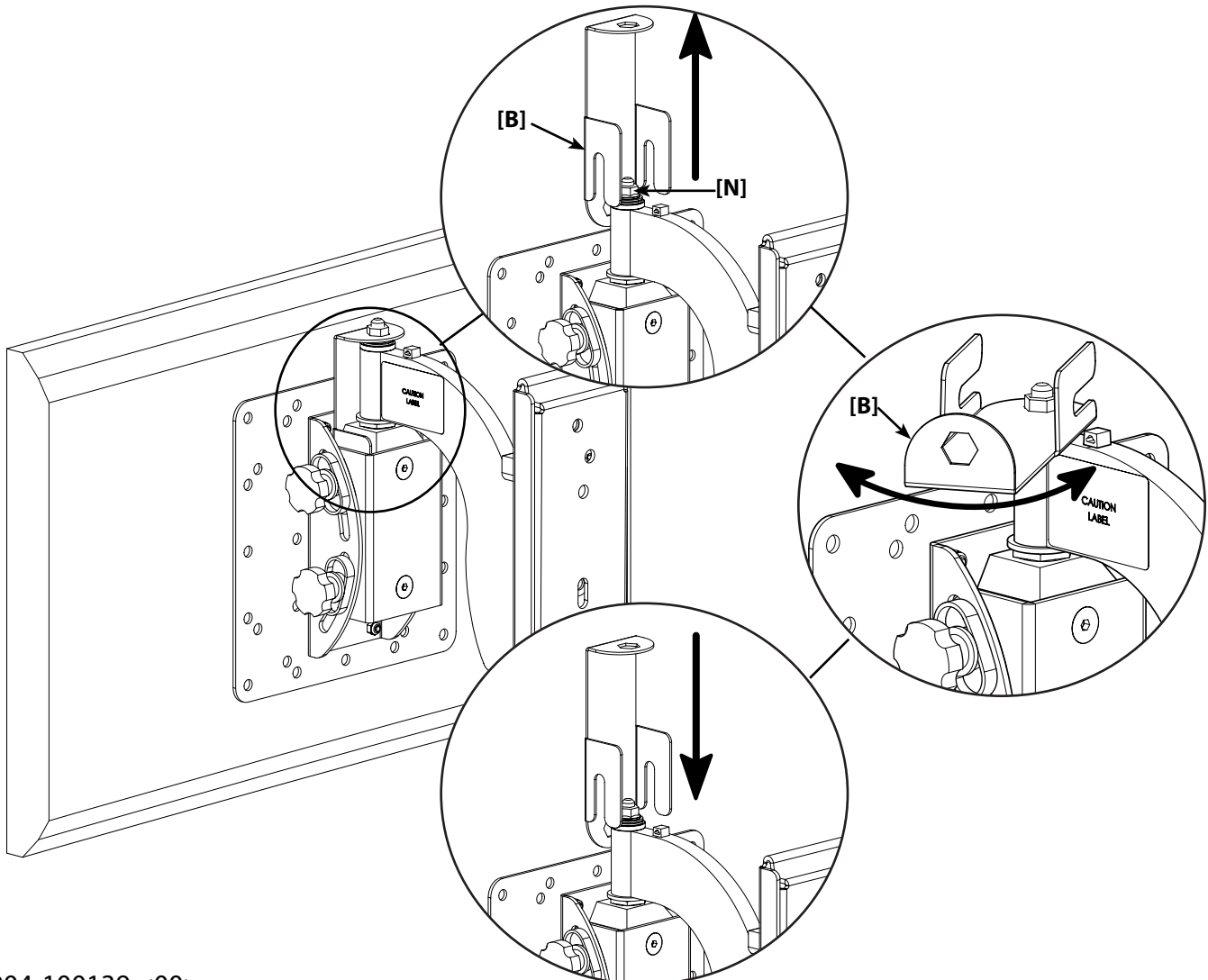

Milestone AV Technologies, Inc. and its affiliated corporations and subsidiaries (collectively, "Milestone"), intend to make this manual accurate and complete. However, Milestone makes no claim that the information contained herein covers all details, conditions, or variations. Nor does it provide for every possible contingency in connection with the installation or use of this product. The information contained in this document is subject to change without notice or obligation of any kind. Milestone makes no representation of warranty, expressed or implied, regarding the information contained herein. Milestone assumes no responsibility for accuracy, completeness or sufficiency of the information contained in this document.